

Thompson Breast Retractor System User Manual:
SET UP INSTRUCTIONS FOR THOMPSON BREAST RETRACTOR SYSTEMS

Thompson Breast Retractor System User Manual

CAUTION: Avoid compressing the patient's body with frame components to prevent nerve damage.

The Thompson Retractor is provided in a non-sterile condition. Refer to Thompson Retractor IFU for cleaning, sterilization, and care instructions.

Reference the Thompson Retractor IFU for additional warnings and cautions.

For other Thompson Retractor Systems, reference corresponding User Manual for each.

Frame Set Up Instructions: Direct Attachment to Elite Rail Clamp

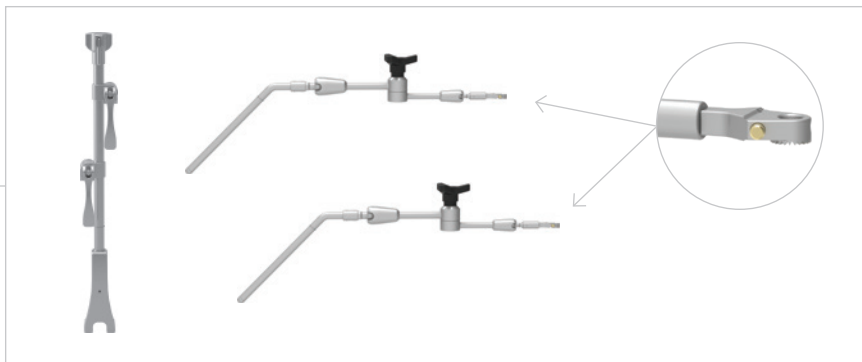
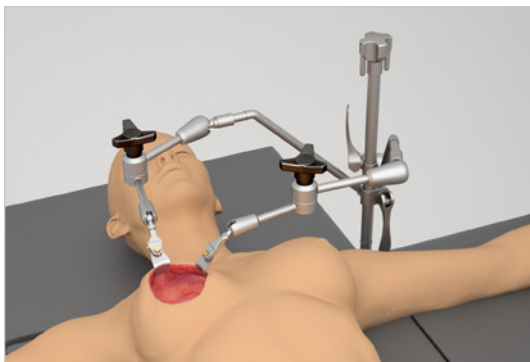

FRAME STEP 1: RAIL CLAMP

Place Elite Rail Clamp onto the rail over the sterile drape and turn top knob clockwise to tighten.



FRAME STEP 2: ADD ARTICULATING ARMS

Insert the articulating arm into the joint on the Elite Rail Clamp, position, and flip the cam joint handle to lock. Repeat with second articulating arm and second joint. Once in place, adjust the articulating arm by turning the black knob counter-clockwise to loosen and clockwise to tighten.

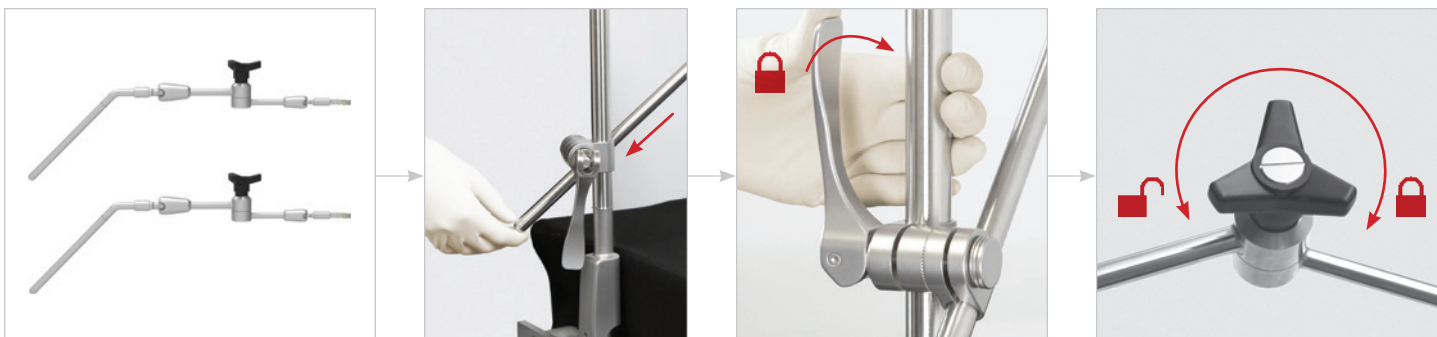

Frame Set Up Instructions: Optional Crossbar Attachment



FRAME STEP 1: RAIL CLAMP

Place Elite Rail Clamp onto the rail over the sterile drape and turn top knob clockwise to tighten. (Images shown Step 1 previous page.)

FRAME STEP 2: CROSSBAR

Insert the crossbar into the joint on the Elite Rail Clamp, position, and flip cam joint handle to lock.

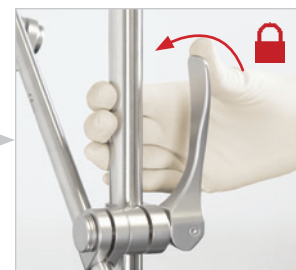

FRAME STEP 3: ADD ARTICULATING ARMS

Insert articulating arm into the joint on the crossbar, position, and flip the cam joint handle to lock. Repeat with second articulating arm and second joint. Once in place, adjust the articulating arm by turning the black knob counter-clockwise to loosen and clockwise to tighten.

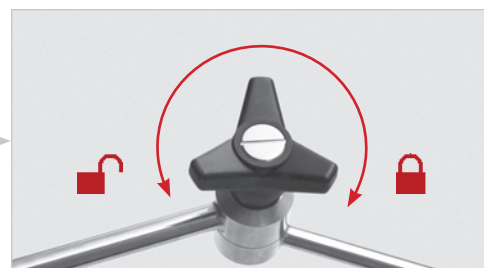

Adding Retractor Blades

S-LOCK® ARTICULATING ARM + BLADES

Attach blade to articulating arm by pushing plunger and inserting blade nipple. Push plunger to release blade and switch between 'swivel' and 'locked' positions.

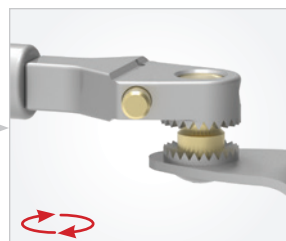
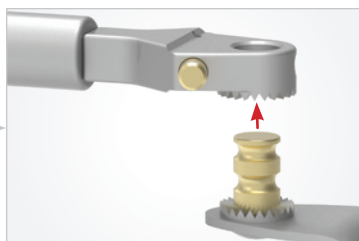
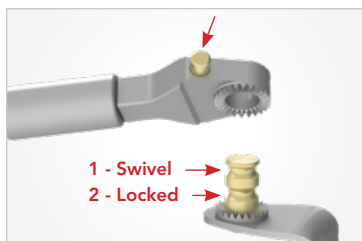

Frame Set Up Instructions: C-Frame

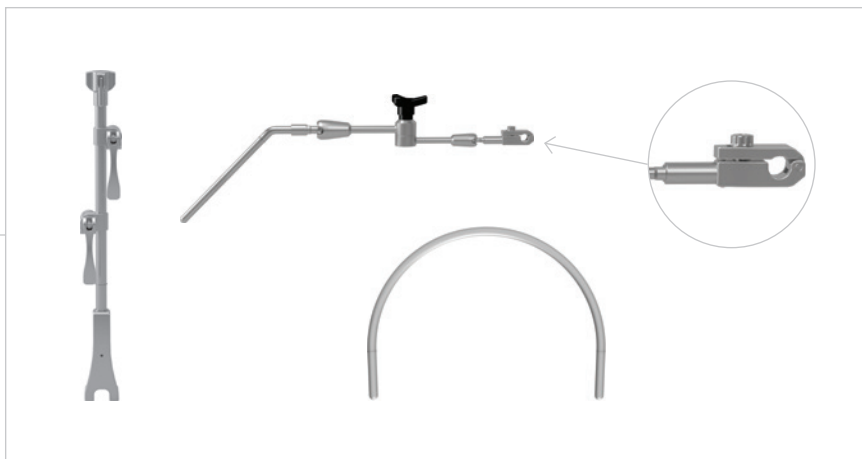
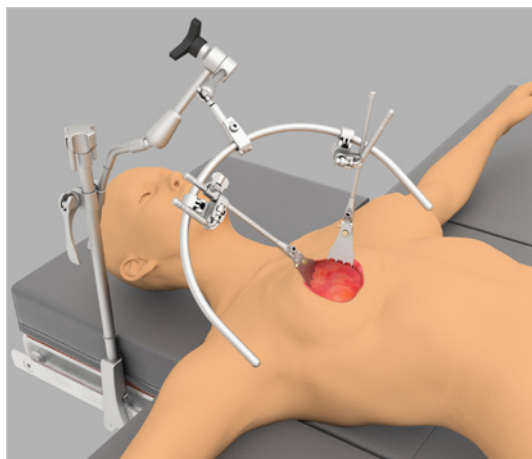

FRAME STEP 1: RAIL CLAMP

Place Elite Rail Clamp onto the rail over the sterile drape and turn top knob clockwise to tighten.



FRAME STEP 2: ADD EXTENSION ARM

Insert the extension arm into the joint on the Elite Rail Clamp, position, and flip the cam joint handle to lock. Once in place, adjust the extension arm by turning the black knob counter-clockwise to loosen and clockwise to tighten.

TIP: For easier attachment, tighten the black knob before this step, keeping the adjustable portion of arm in place.

TIP: Further adjustment may be needed after C-Frame has been added in the next step.

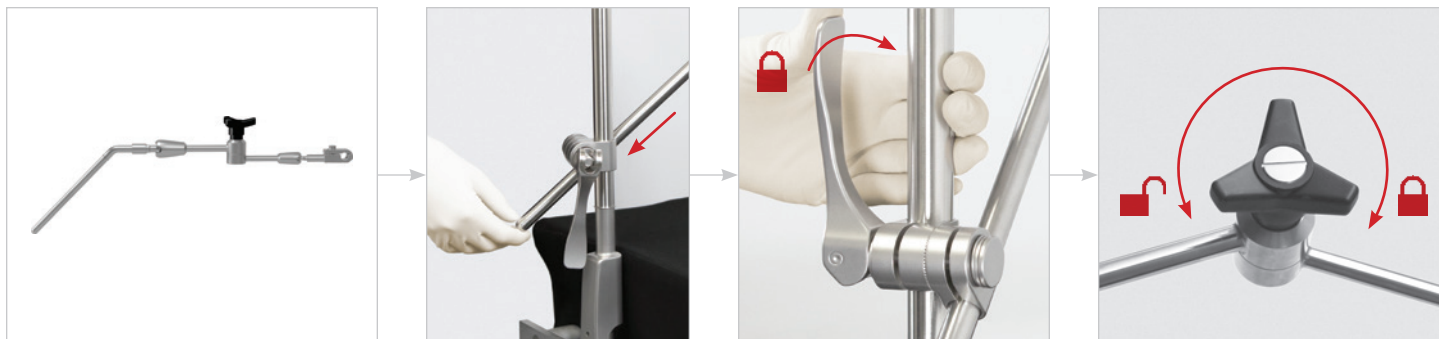

Frame Set Up Instructions: C-Frame (Continued)

FRAME STEP 3: ADD C-FRAME

Place C-Frame in hinge joint on Articulating Arm. Use T-Handle to tighten.

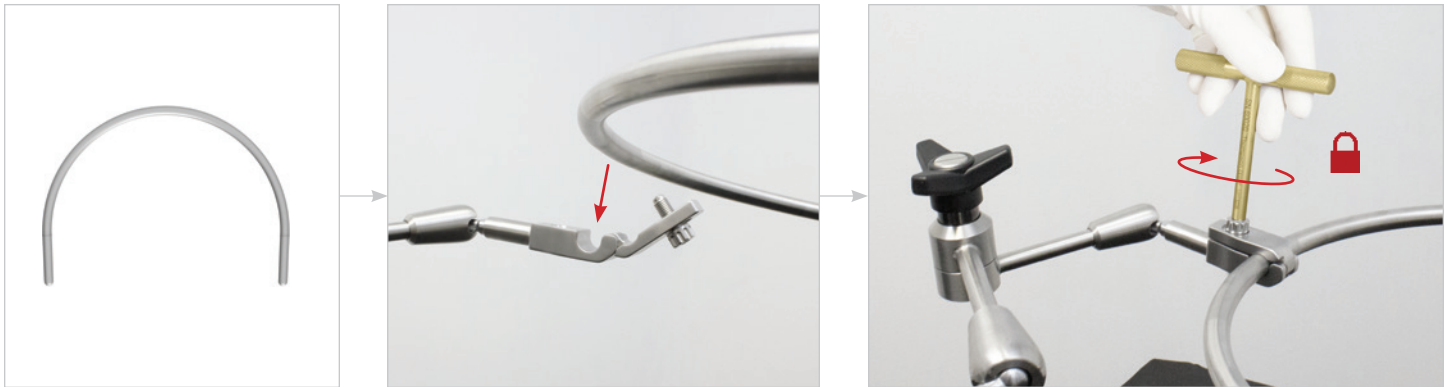

Lite Wand Xe Instructions

LITE WAND XE STEP 1: ADD LITE WAND TO FRAME

Clip the Lite Wand Xe joint anywhere on the retractor frame that will allow the distal end of the light to illuminate deep into the incision.

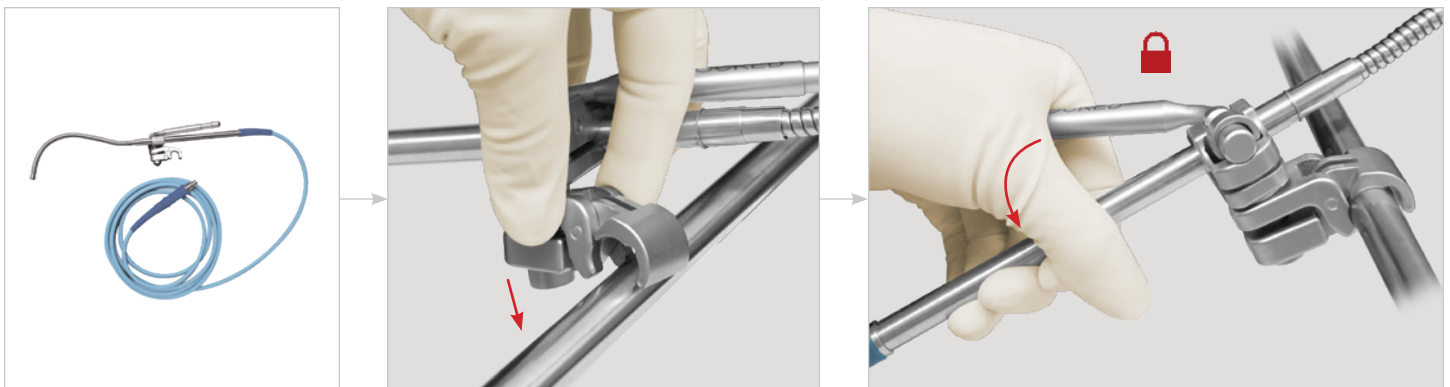

LITE WAND XE STEP 2: ADJUST LITE WAND

Bend the gooseneck to position the distal end of the Lite Wand Xe above the incision.

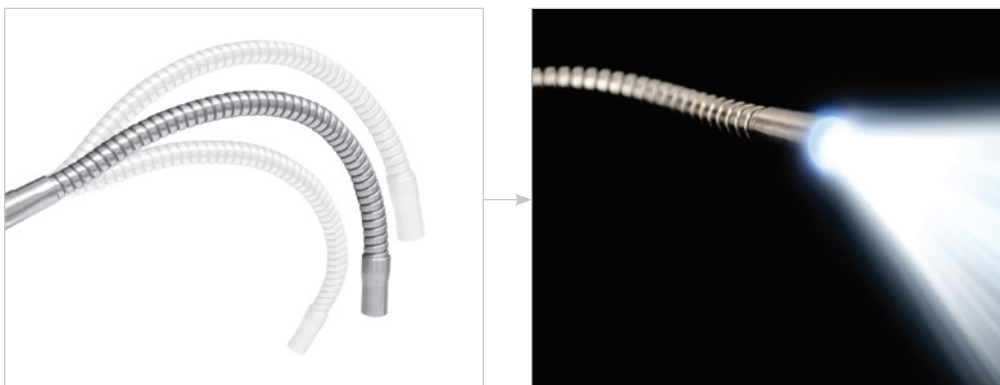

Handles + Blades

S-LOCK® HANDLES + BLADES

Attach blade to handle by pushing plunger and inserting blade nipple. Push plunger to release blade and switch between 'swivel' and 'locked' positions.

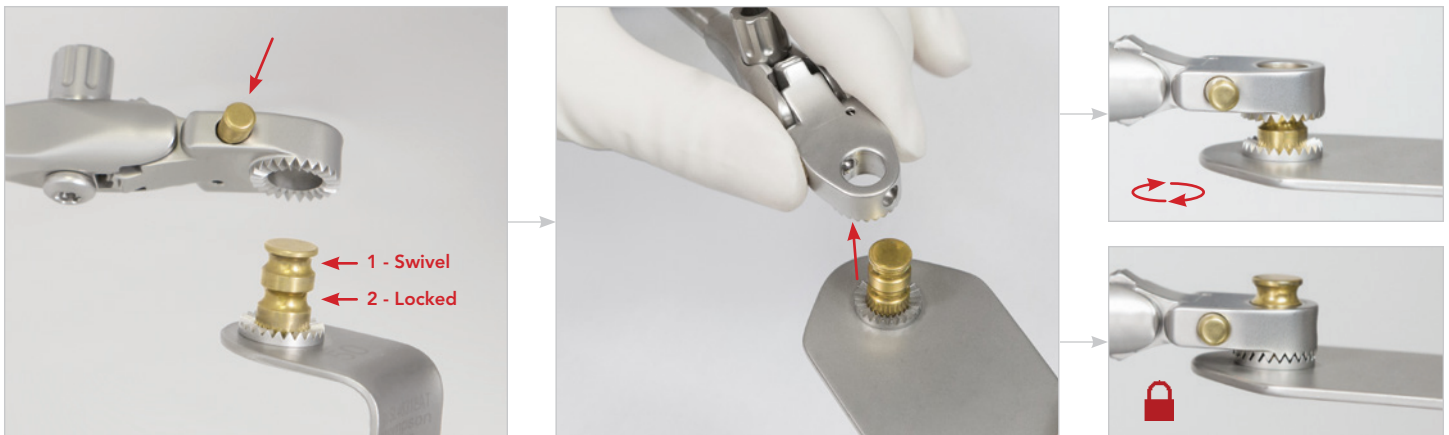

QUICK ANGLE HANDLES

Blades may be angled 45° up or down by hand or with T-Handle.



MINI MICRO-ADJUSTABLE HANDLES

Retract blades further by turning the Mini Micro-Adjustable Handle knob clockwise. Release tension by pressing the pawl.

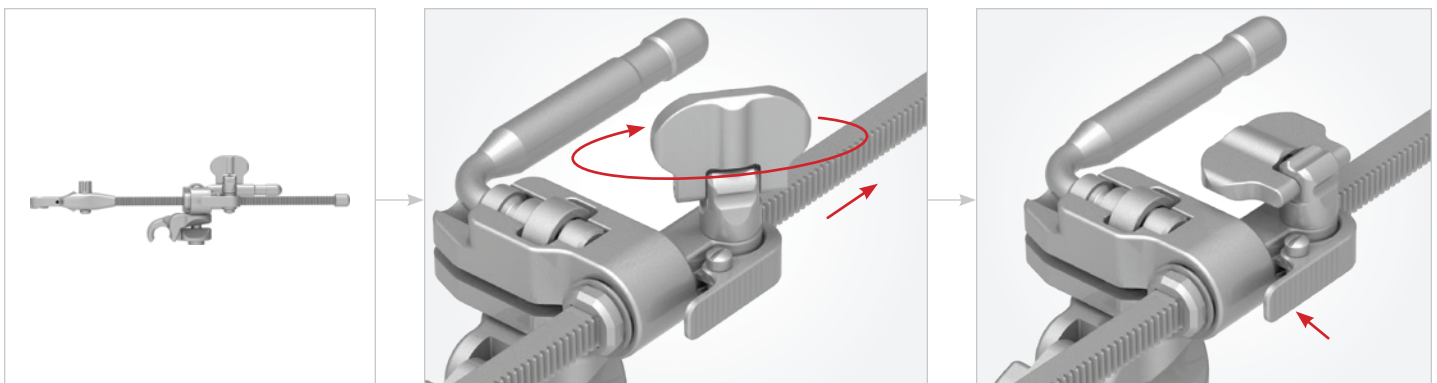

Handles + Blades (Continued)

CLIP-ON HANDLE ATTACHMENT

With joint in unlocked position, clip to frame in desired location, position blade in the incision, and flip the cam joint handle to lock in place.

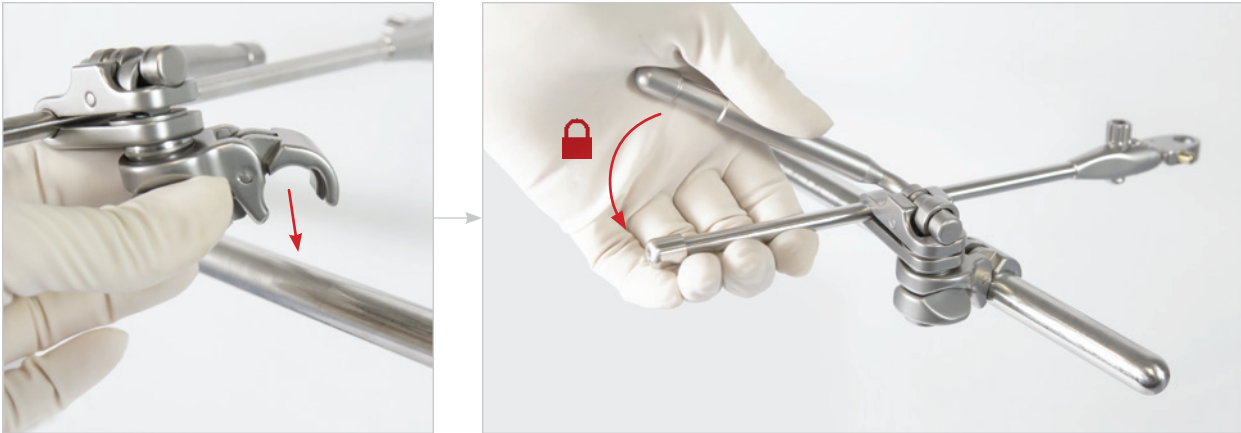

CLIP-ON HANDLE REMOVAL

Flip cam joint handle to unlocked position, pinch back of cam joint with thumb and index finger, and gently lift up off of arm.

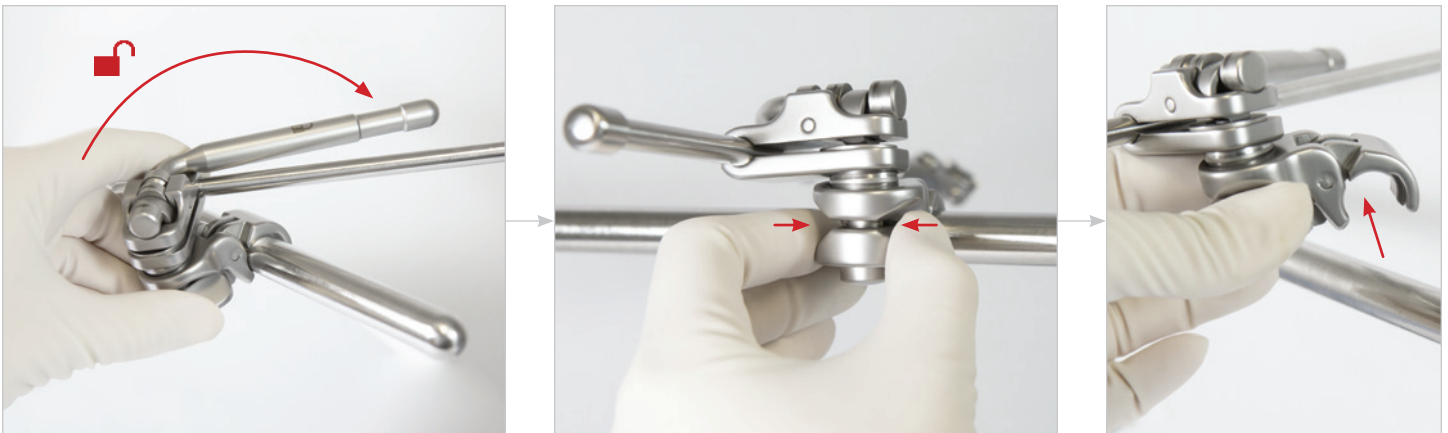

For a Free Trial Call Today*

1.800.227.7543

Rev C
011123
dc brstum



Uncompromised Exposure

VISIT US ONLINE: THOMPSONSURGICAL.COM



Thompson
SURGICAL INSTRUMENTS

10341 East Cherry Bend Road
Traverse City, Michigan 49684
phone: 231.922.0177
fax: 231.922.0174
thompsonsurgical.com

EC REP

Emergo Europe

Westervoortsedijk 60
6827 AT Arnhem
THE NETHERLANDS

* Free trial valid for U.S. customers only. Customers outside U.S. please call +1-231-922-0177 for availability.

© 2022 Thompson Surgical Instruments, Inc. Printed in the U.S.A.

@ S-Lock® and the "T Circle" logomark are Registered Trademarks of Thompson Surgical Instruments, Inc.
Patents: trpat.com

Note: As we continually strive to provide the best products possible, some of the images in this document may appear slightly different from the product received.

CE 0297

Made In
USA