

## Colon / Rectal System SUGGESTED SET UPS

### Lithotomy Colon / Rectal

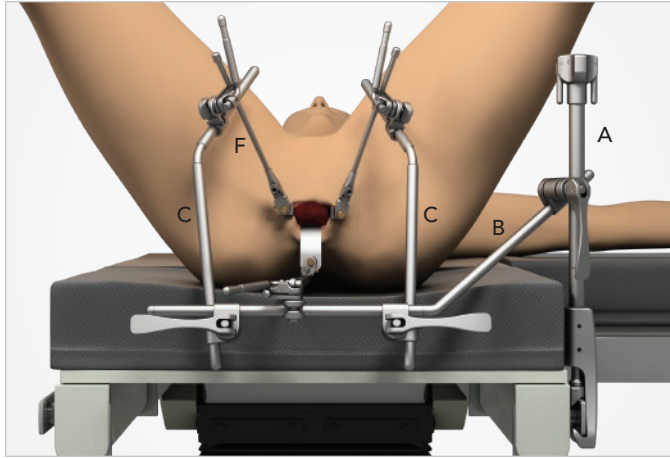

### Prone Jack Knife Colon / Rectal

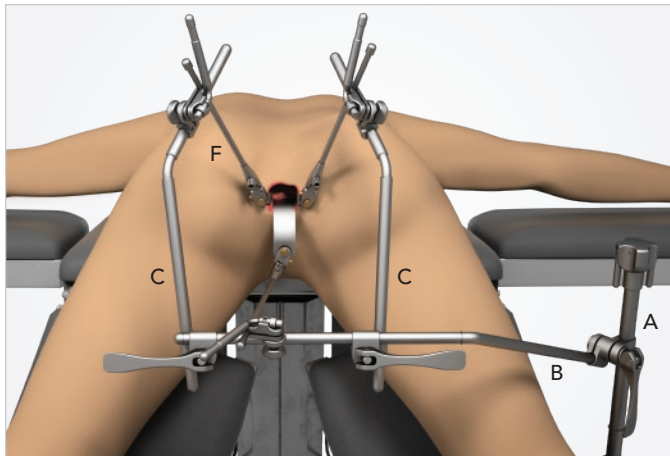

### Abdominal Colon / Rectal

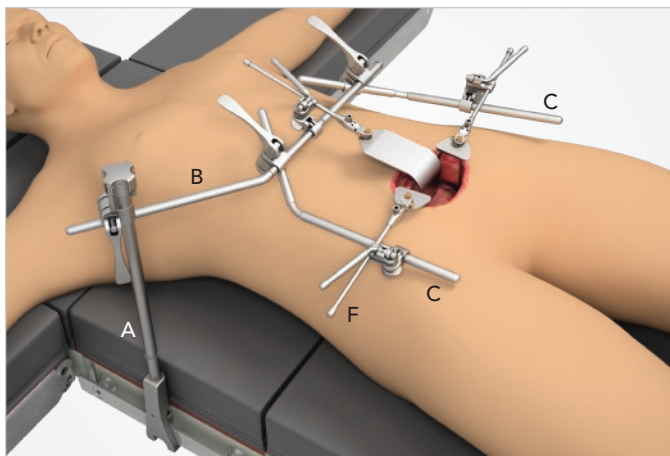

### COLON / RECTAL SYSTEM

#SL82002

REF	PART #	ITEM DESCRIPTION	QTY
<b>Tray 1</b>			
A	43902AC	Elite III Rail Clamp with 1 Cam Joint 18"	1
B	43900BC	24" Crossbar with 2 Cam III Joints (11" x 13")	1
C	44118N	18" Angled Arm (8" x 10") @ 45°	2
D	44124N	24" Angled Arm (8" x 16") @ 45°	2
E	44118B	18" Angled Closure Arm (9" x 9")	1
	50000G	Instrument Case (23" x 11" x 3 1/2")	1
<b>Tray 2</b>			
F	SL42126WGP	Cam II Clip-on Quick Angle 8"	3
G	SL45006CGP	Micro-Adjustable II Clip-on Quick Angle 10"	2
H	60020	T-Handle	2
I	SL46143	Fenestrated 44mm x 89mm (1 3/4" x 3 1/2")	2
J	SL46170	Deaver 25mm x 127mm (1" x 5")	2
K	SL46185	Hill-Ferguson 32mm x 76mm (1 1/4" x 3")	1
L	SL46186	Hill-Ferguson 25mm x 64mm (1" x 2 1/2")	1
M	SL46187	Rectal Blade 13mm x 117mm (1/2" x 4 1/2")	2
N	SO46187A	St. Marks [no lip] 64mm x 178mm (2 1/2" x 7")	1
O	SO46188	St. Marks [with lip] 64mm x 178mm (2 1/2" x 7")	1
P	SO46189	St. Marks [with lip] 64mm x 140mm (2 1/2" x 5 1/2")	1
	50000G	Instrument Case (23" x 11" x 3 1/2")	1

"Thompson Surgical provides **the most hassle-free, versatile retractor**. For those complex, difficult procedures, as well as the routine, its ease of setup, strength and use, as well as lack of constant readjustment, **always provides me reliable and safe exposure.**"

- Michael Nizzi, DO, FACOS

### Colon / Rectal System COMPONENTS

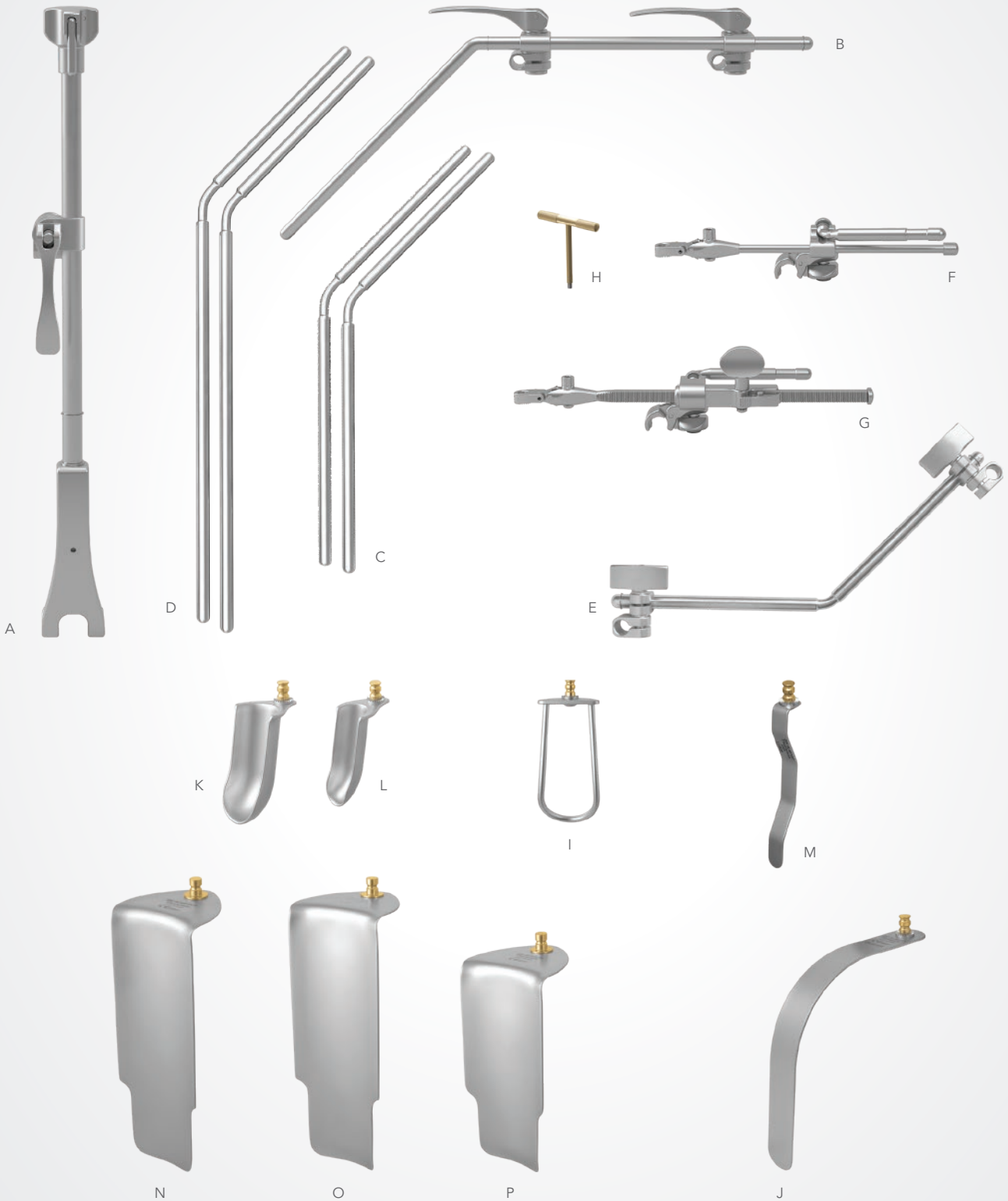

RETRACTOR SYSTEMS